

1064 High Power Polarization Insensitive Isolator

Features:

- Low Insertion Loss
- High Isolation
- High Power Handling
- High Return Loss



Applications:

- Fiber laser
- Instrumentation
- Fiber Amplifier
- Lab Research

Specifications:

Parameter		Unit	
Central Wavelength (λ_c)		nm	1064
Operating Wavelength Range		nm	+ / - 10
Peak Isolation	Typ.	dB	32
Isolation (23 °C)	Min.	dB	25
Insertion Loss (λ_c , 23 °C)	Typ.	dB	0.8
	Max.	dB	1.2
Return Loss (input/output)	Min.	dB	50 / 50
Polarization Dependent Loss	Max.	dB	0.15
Fiber Type			HI 1060 Fiber
Fiber Length	Min.	m	1.0
Optical Power (CW) ¹	Max.	W	5, 7, 10 or specify
Tensile Load	Max.	N	5

1. For pulse applications, please inform us before you place order.

Dimension:

Figure 1. 1064 High Power Polarization Insensitive Isolator

Order Information:

 KHPI - XXXX - XX - XXXX - XX
 | | | |
 A B C D

A	Wavelength	S=Single stage
		1064=1064nm
B	Optical Power	05=5W
		07=7W
		10=10W
		S=Specify
C	Fiber Type	250S=250 μm bare fiber
		900L=900 μm loose tube
D	Connector	NN=W/O connector
		XY=With connector ¹

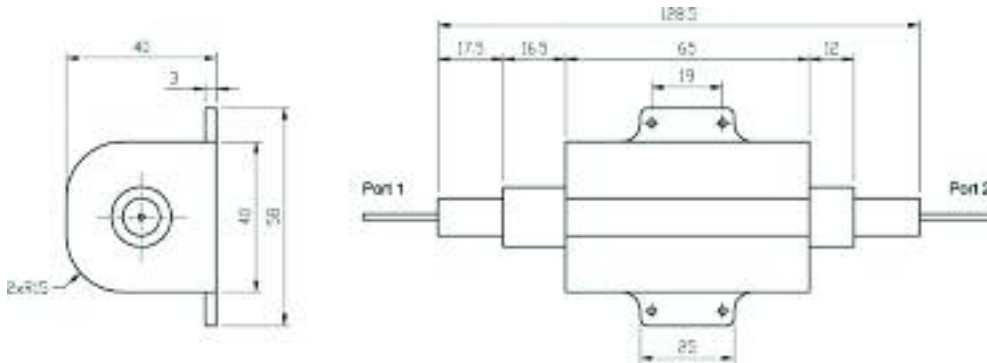
1. Please specify type of connector as below when ordering.

Mechanical Type	Other	SC	FC	ST	MU	LC
X	0	1	2	3	4	5
Physical Contact Type	Other	PC	UPC	APC		
Y	0	1	2	3		