



▶ **GDLM1000 series product is standard GDL module with internal photodiode, which provides a stable performance under room temperature range. It can deliver TEM<sub>00</sub> and low divergence output beam. Up to 50mW output power is available.**

### Key Features:

- ▶ Auto Power Control Function
- ▶ High Reliability
- ▶ Low Cost

### Applications:

- ▶ Surveying Equipments
- ▶ Laser Alignment and Positioning
- ▶ Laser Aiming
- ▶ Machine vision

Specifications		GDLM-1005	GDLM-1010	GDLM-1020	GDLM-1050
CW Output Power ( Typ)		5mW	10mW	20mW	50mW
Wavelength ( Typ)		532nm			
Beam Mode		TEM <sub>00</sub>			
Mode Quality ( M <sup>2</sup> )		<1.2	<1.4		
Beam Roundness		>85%			
Power Stability	APC, over 2hrs at ambient temperature +/-2°C after warm up	<±5%			
	APC, over operating temperature range	<±20%			
Beam Alignment Tolerance	Position ( Δr )	<0.5mm			
	Angle	<10mrad			
Linear Polarization		Unpolarized <sup>1</sup>			
LD Operating Voltage		<2.0v	<2.3v		
LD Operating current ( Max )		300mA	600mA		
Operating Temperature		+20~+30°C			
Operating Humidity		5%~95% (Non-condensed)			
Storage Temperature		-20~+60°C			
Residual IR		<0.2%			
Expected Operating Lifetime		>5000 hours			
Recommended DC Driver		LDD-360C	LDD-360C	LDD-800D	LDD-800D
Recommended AC Power Supply		LDD-800A	LDD-800A	LDD-800A	LDD-800A

1. Linear Polarized Module could be supplied upon request.

► **Dimension & Beam Parameters:**

Collimator Type	Laser Head Dimension	Beam Diameter (1/e <sup>2</sup> )	Beam Divergence (Full Angle)
7.5*	Φ 12mm*35mm	1.2mm	1.2mrad
15*	Φ 13mm*44mm	2.5mm	0.7mrad

► **Order information**

GDLM 10XX - CXX

Magnification factor of collimator, C7.5 represents 7.5\* collimator, C15 represents 15\* collimator.

Output power, 05 represents 5mW, 50 represents 50mW.

**Package Drawing (Unit:mm)**

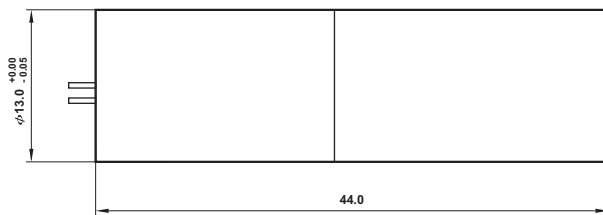

Pin Configurations : 1. LD Cathode 2. PD Anode 3. Com\*  
Note : \* LD Anode and PD Cathode

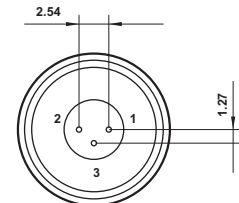

Bottom View

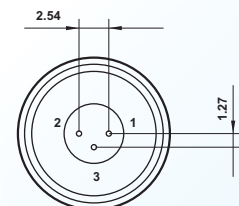

Bottom View