



## Narrow Linewidth 785nm Laser

**Key Features:**

- Fiber Coupled Output
- Up to 500mW Output
- Low Power Consumption
- Narrow Spectral Bandwidth<0.1nm
- Temperature Stabilized Spectrum (<0.005nm/°C)

**Applications:**

- Sensing
- Bio-Medical
- Raman Spectrometer

Model Number		RLAS-785			
Optical Parameters		Min	Typ	Max	Conditions
Peak Wavelength		784nm	785nm	786nm	
Output Power			300mW	500mW	ACC mode
Power Stability (Over 2 hours,25°C)			±2%		
Operating Temperature (case)		10-40 °C			
Spectral Line Width (FWHM)			0.08nm	0.1nm	
Peak Wavelength Drift			0.005nm/°C		
Warm-Up Time		<1min			
Electrical Parameters					
LD Working Voltage			2V	2.3V	
LD Working Current				1800mA	
Internal TEC	Voltage			4.8V	
	Current			2.5A	
Thermal Resistance			10KOhm		@25°C (RTD)
Fiber Parameters					
Fiber Type		105/125um Multimode Fiber			
Fiber Numerical Aperture		0.22			
Fiber Connector		FC/APC or to be Customized			
Other Parameters					
Storage Temperature		-40 to +85 deg C			
Expected Lifetime		>10000hrs			

## Wavelength Spectrum

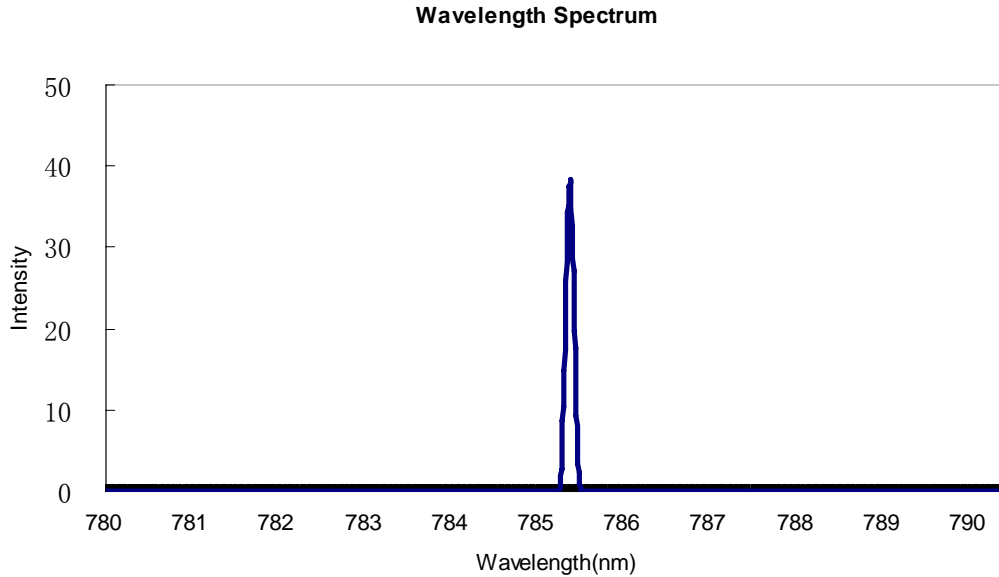

## Order Information:

**RLAS— WWW — PPP — LL — JJ — TT**

WWW: Peak Wavelength	784=784 nm
	785=785 nm
	786=786 nm
PPP: Output Power from Fiber	300=300mW
	500=500mW
LL: Fiber Length	05=0.5M
	10=1M
	15=1.5M
	20=2M
	00= To be Customized
JJ: Fiber Jacket (diameter)	01= 900µm Black Buffer
	02=2.8mm PVC Jacket
	00= To be Customized
TT: Fiber Termination	01=No Connector
	02= FC/APC Connector
	00= To be Customized

## Mechanical Drawing (Unit:mm)

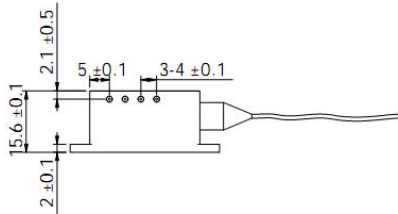
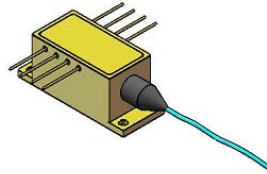
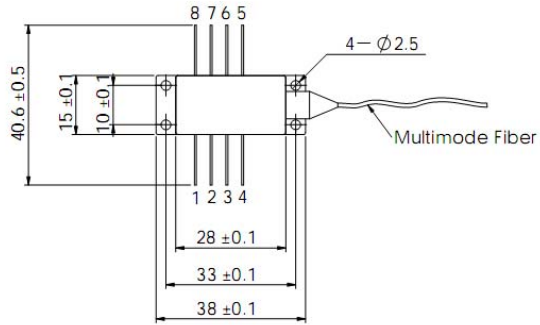

1	TEC-
2	Thermistor
3	Thermistor
4	PD+ *
5	PD- *
6	LD+
7	LD-
8	TEC+

\*: Optional pin-out for some special lasers