

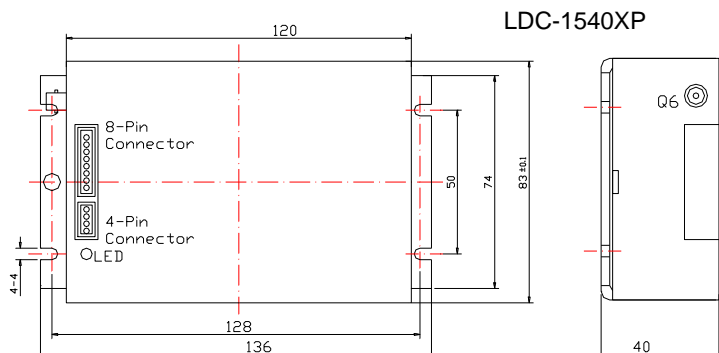

LDC-1540XP

Model Number	LDC-1540XP			
Laser Diode Driver Parameters	Specs			Conditions
	Min	Typ	Max	
Driver Current	0	-	1300mA	
Driver Current Limit	50mA	-	1300 mW	
Max. Driver Voltage	-	-	3.0V	
TTL Modulation	-	DC-10kHz	-	
Temperature Control Parameters				
Max. Driver Current	-	-	1.5A	
Max. Driver Voltage	-	-	8V	
Temperature Sensor	-	10Kohm NTC Thermistor	-	
Mechanical Parameters				
Laser Head Dimensions	Length	-	136mm	-
	Wigth	-	83mm	-
	High	-	40mm	-
Weight	-	320g	-	
Reliability				
Operating Humidity	-	5%~85% R.H.	-	
Operating Temperature	-	-10 to +60 °C	-	
Operating Voltage	-	±12V	-	
Max Power	-	-	25W	

Dimensions and Pin Configuration (Unit: mm)



1.Pins configuration of 4-pin Connector:

PIN 1	+12V	Red cable
PIN 2	0V	Black cable
PIN3	0V	Black cable
PIN4	-12V	Blue cable

2.Pins configuration of 8-pin Connector:

PIN 1	TE+	PIN5	LD-
PIN 2	TE-	PIN6	LD+
PIN 3	Rth	PIN7	PD+
PIN 4	Rth	PIN8	PD-